

REVISION HISTORY						
CHG NO	ZONE	REV	DESCRIPTION	DATE	BY	APPROVED
00-00365	ALL	1	NPT ADAPTERS UPDATED	8-2-00	DAV	MLW
01-0270	D4, D5	2	ADDED LOCKWASHERS & CAP SCREW HEADS TO ADAPTERS	5-30-01	KV	KV
01-0287	ALL	3	ALL ADAPTERS UPDATED TO REFLECT 9/99 ANCHOR CATALOG	6-11-01	DMM	DMM

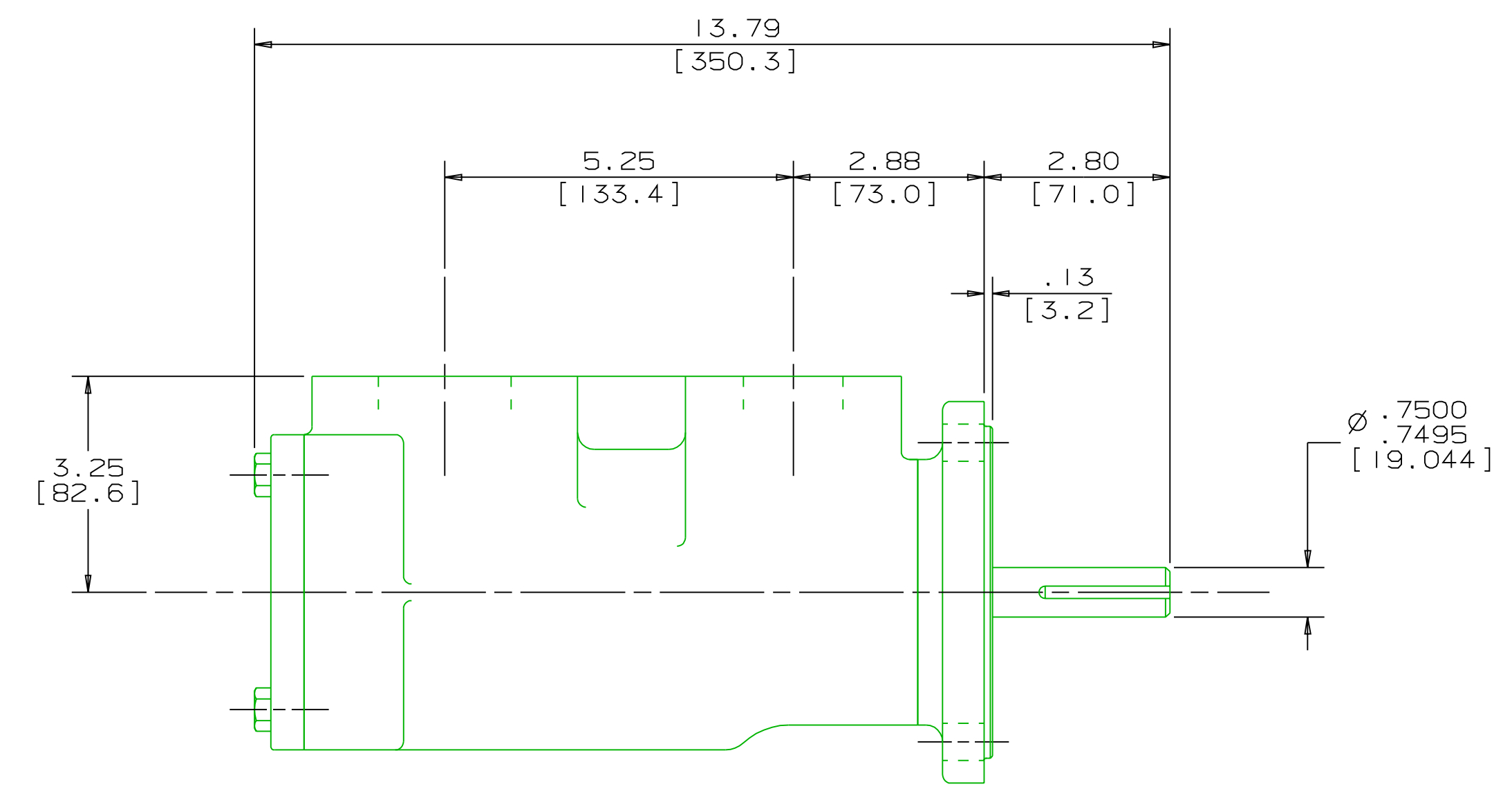
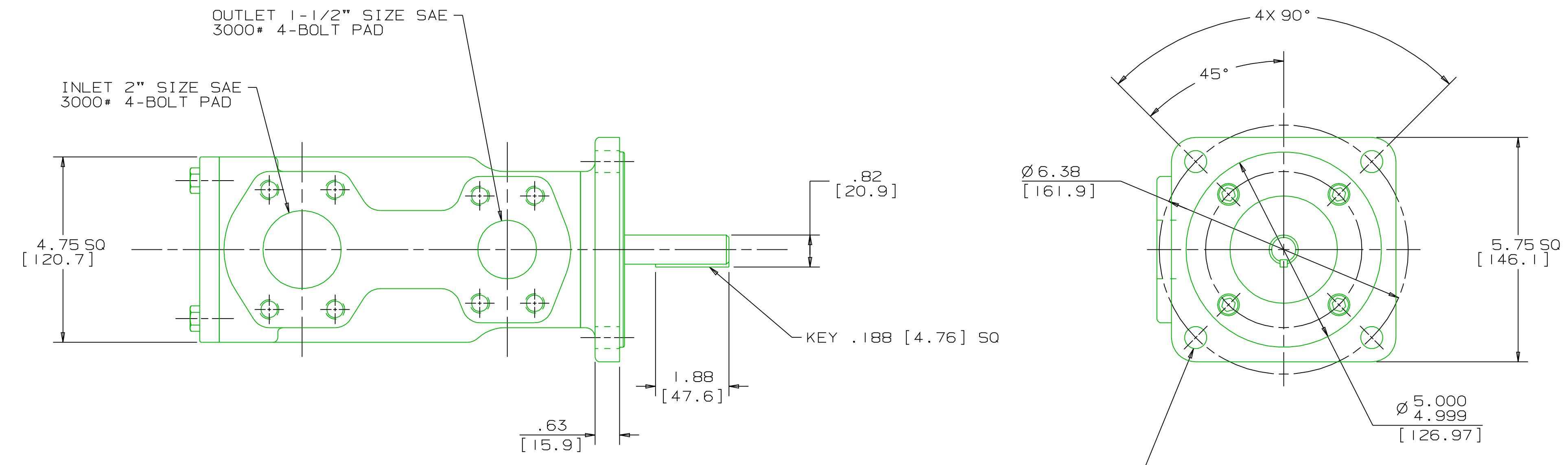
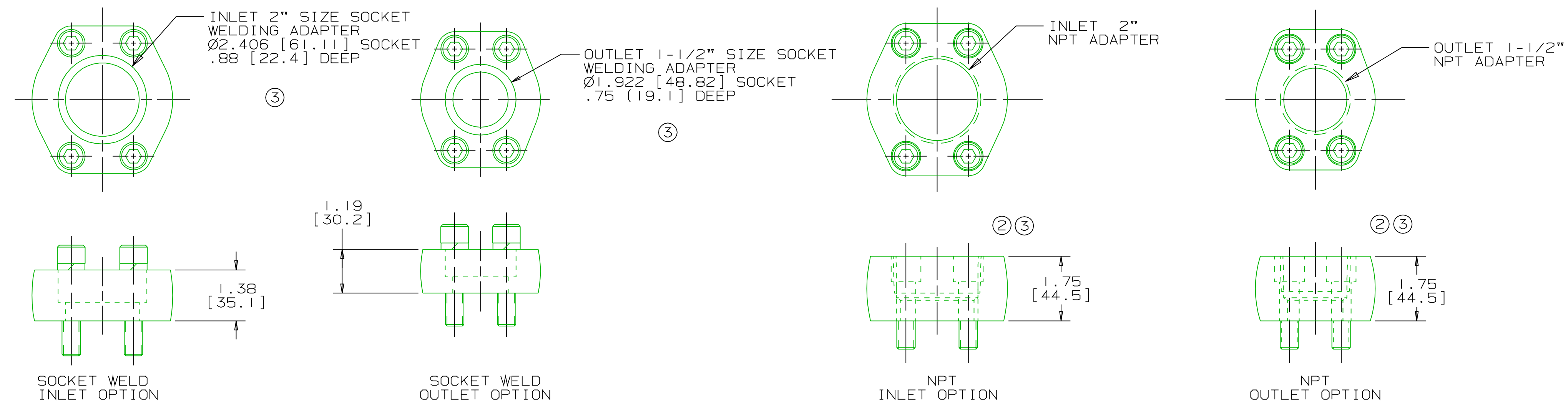

← ROTATION →

DRAWING CERTIFICATION	
CUSTOMER NAME	-----
CUSTOMER PO NUMBER	---
CUSTOMER PART NUMBER	-
BOM NUMBER	-----
PUMP TYPE	-----
SHAFT ROTATION	-----
INLET PORT OPTION	----
OUTLET PORT OPTION	---
OTHER INFORMATION	
CERTIFIED BY	-----
CERTIFIED DATE	-----
IMO ORDER NUMBER	-----
DATA REVISION NUMBER	-

NOTES:
 1. UNLESS OTHERWISE SPECIFIED, ALL DIMENSIONS ARE IN INCHES. DIMENSIONS IN [] ARE MILLIMETERS.

WEB ADDRESS: WWW.IMO-PUMP.COM EMAIL: IMO.PUMP@COLFAXCORP.COM

DRAWN WLW 4-25-00
 CHECKED WLW 5-17-00
 APPD WLW 5-17-00

Imo Pump
 1710 Airport Road
 PO Box 5020
 Monroe, NC USA
 28111.5020

TITLE
 OUTLINE STANDARD _3E1CS-143_/162_

THIRD ANGLE PROJECTION FIRST ORDER

SIZE CAGE CODE DWG NO
 D 59180 SDD 19925

USED ON 3252/620 SCALE 1/2 WEIGHT 38 LBS [17.2 kg] SHEET 1 OF 1

MATERIAL

PROCESS

COMMENTS:
 STANDARD ROTATION IS CLOCKWISE WHEN VIEWED FROM COUPLING END OF PUMP. SUCTION STRAINER AND DISCHARGE RELIEF VALVE MUST BE PROVIDED.
 ALIGNMENT:
 UNITS ARE ACCURATELY ALIGNED AT THE FACTORY. ALIGNMENT SHOULD BE CHECKED BEFORE STARTING TO ENSURE THAT IT IS STILL WITHIN .005 [0.13] FTW.
 PRESTARTING:
 FLUSH SUCTION PIPING BEFORE CONNECTING PUMP. PRIME AND VENT PUMP. DO NOT START PUMP WITH VALVES CLOSED. READ INSTRUCTION MANUAL FOR DETAILS BEFORE STARTING.